



DOUGLAS COLLEGE

CAMPUS GUIDE

COQUITLAM CAMPUS 2020-2021

douglascollege.ca

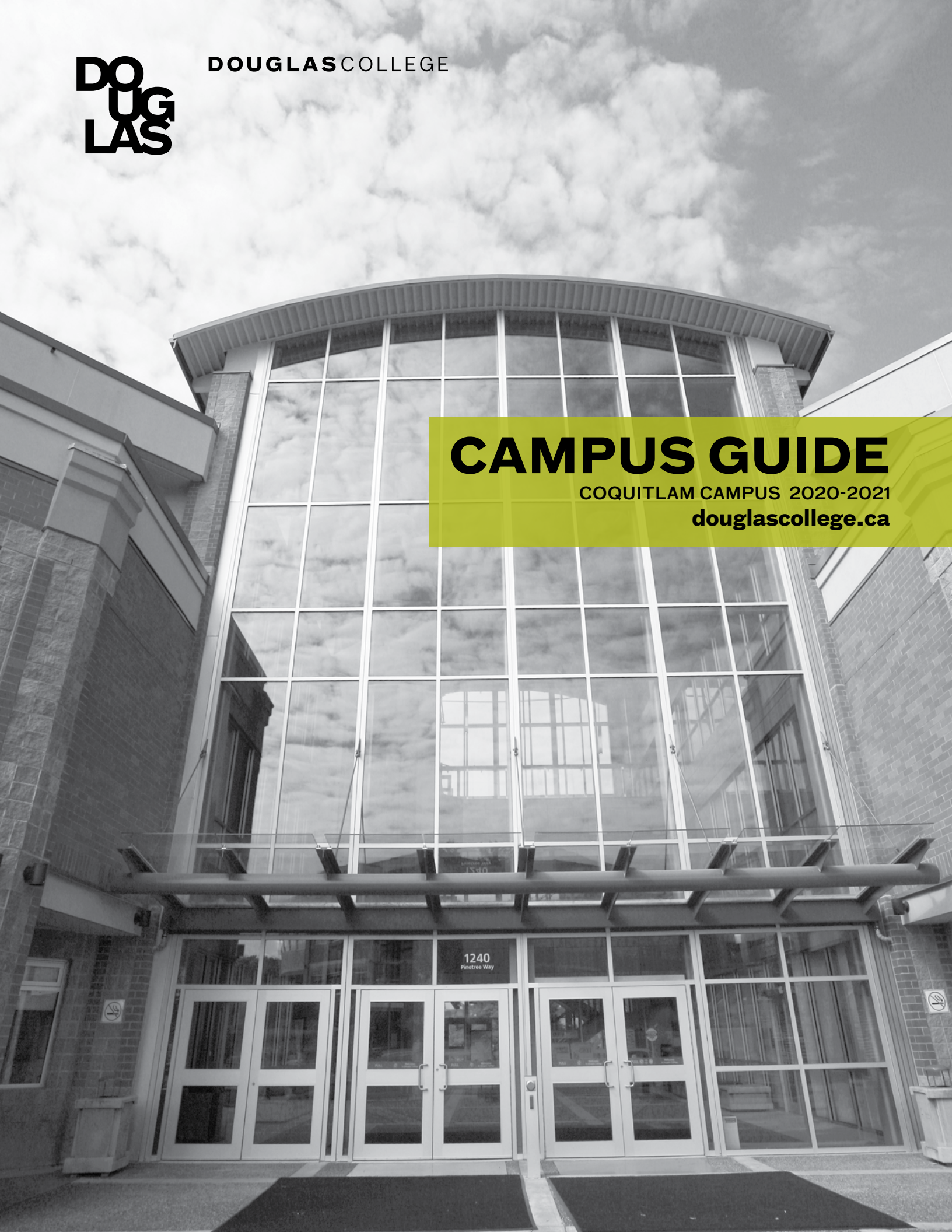



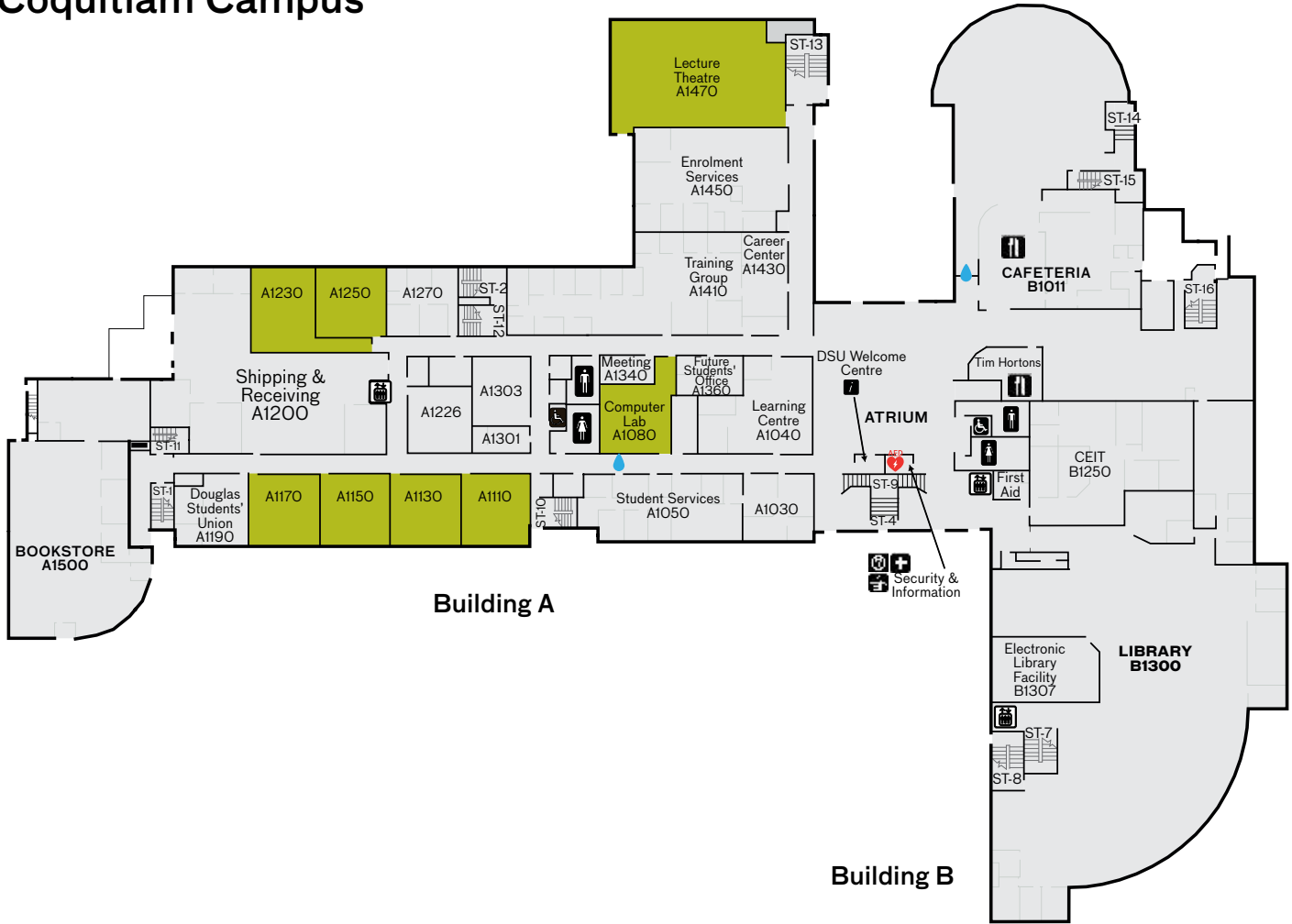

DOUGLAS COLLEGE

First Floor - Building A & B Coquitlam Campus





LEVEL 1

A1040	Learning Centre	B1011	Cafeteria
A1050	Student Services	B1250	Centre for Educational & Information Technology
	• Counselling	B1300	Library
	• Accessibility Services	B1307	Electronic Library Facility
A1080	Computer Lab		Water Fill Station
A1190	Douglas Students' Union		AED Location
A1192	Student Engagement		
A1200	Shipping & Receiving		
A1301	International Education		
A1360	Future Students' Office		
A1410	The Training Group		
A1430	Career Centre		
A1450	Enrolment Services		
A1470	Lecture Theatre		
A1500	Bookstore		

Second Floor - Building A & B Coquitlam Campus



LEVEL 2

A2040	Dispensing Opticianry	B2002	Faculty of Language, Literature & Performing Arts
A2030	Computer Lab	B2100	Video Conferencing Room
A2081	Therapeutic Recreation	B2190	Language Lab
A2095	Math Lab	B2210	Physical Geography
A2100	Physics/Geology	B2230	Geography Lab
A2110	Computer Lab	B2270	Psychology Lab
A2130	Computer Lab		Water Fill Station
A2143-45	Veterinary Technology		AED Location
A2163	Biology		
A2190	Chemistry		
A2270	Computer Lab		
A2280-90	Hospitality Management Classroom & Lab		

Third Floor - Building A & B Coquitlam Campus

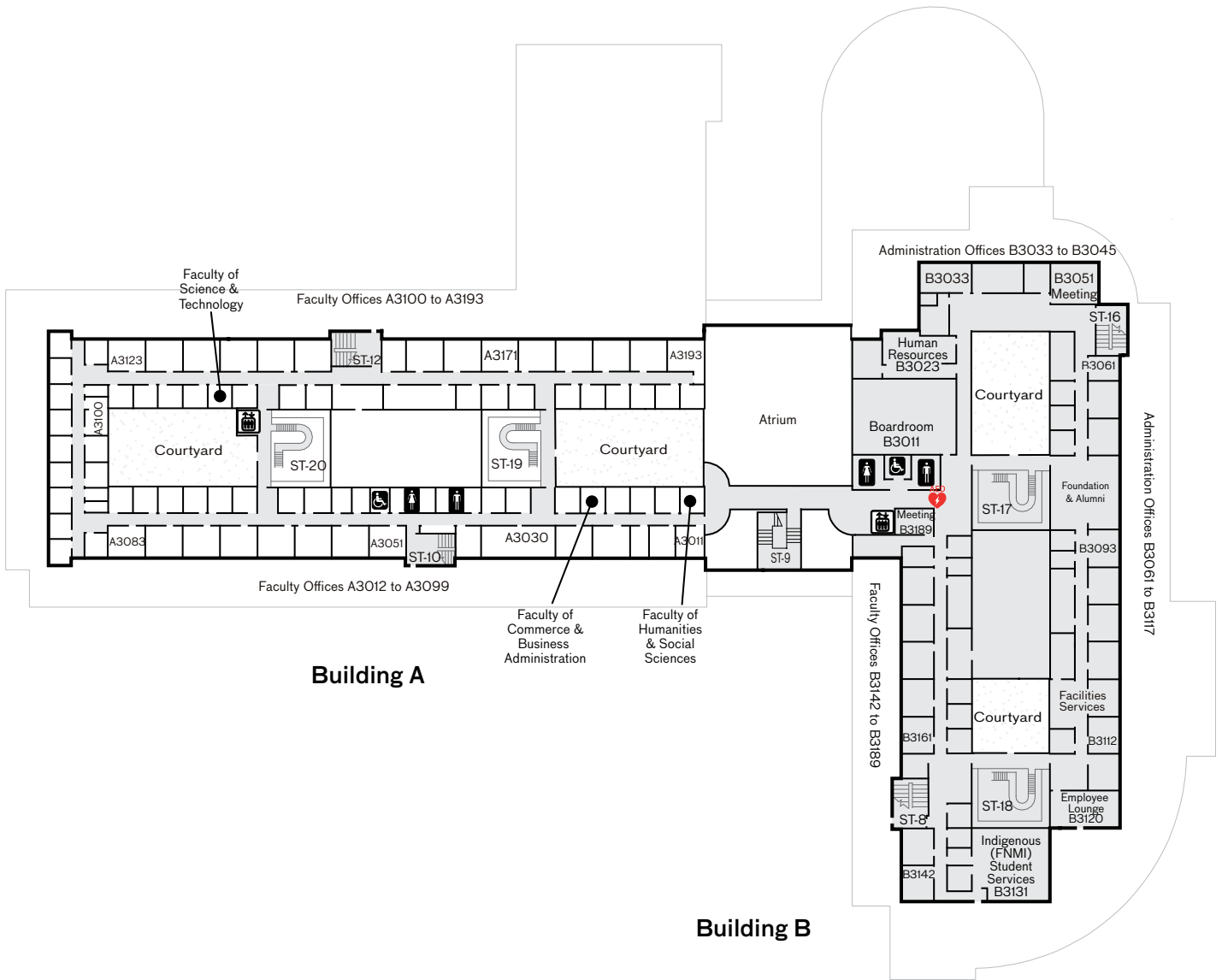



LEVEL 3

A3012	Faculty of Humanities & Social Sciences	B3080	Douglas College Foundation
A3020	Faculty of Commerce & Business Administration	B3090	Alumni Association
A3130	Faculty of Science & Technology	B3112	Facilities Services
B3011	Boardroom	B3120	Employee Lounge
B3023	Human Resources	B3131	Indigenous (FNMI) Student Services
			AED Location

First Floor - Building C & D Coquitlam Campus



LEVEL 1

- D10400 Faculty of Applied Community Studies
-  Water Fill Station
-  AED Location

Second Floor - Building C & D Coquitlam Campus



LEVEL 2

C2009-2050 Faculty of Health Sciences Labs
 D2005 CEIT
 D2010 Health Information Management Lab
 D2012 Computer Lab



D2016
 D2017

Computer Lab
 Computer Lab
 Water Fill Station
 AED Location

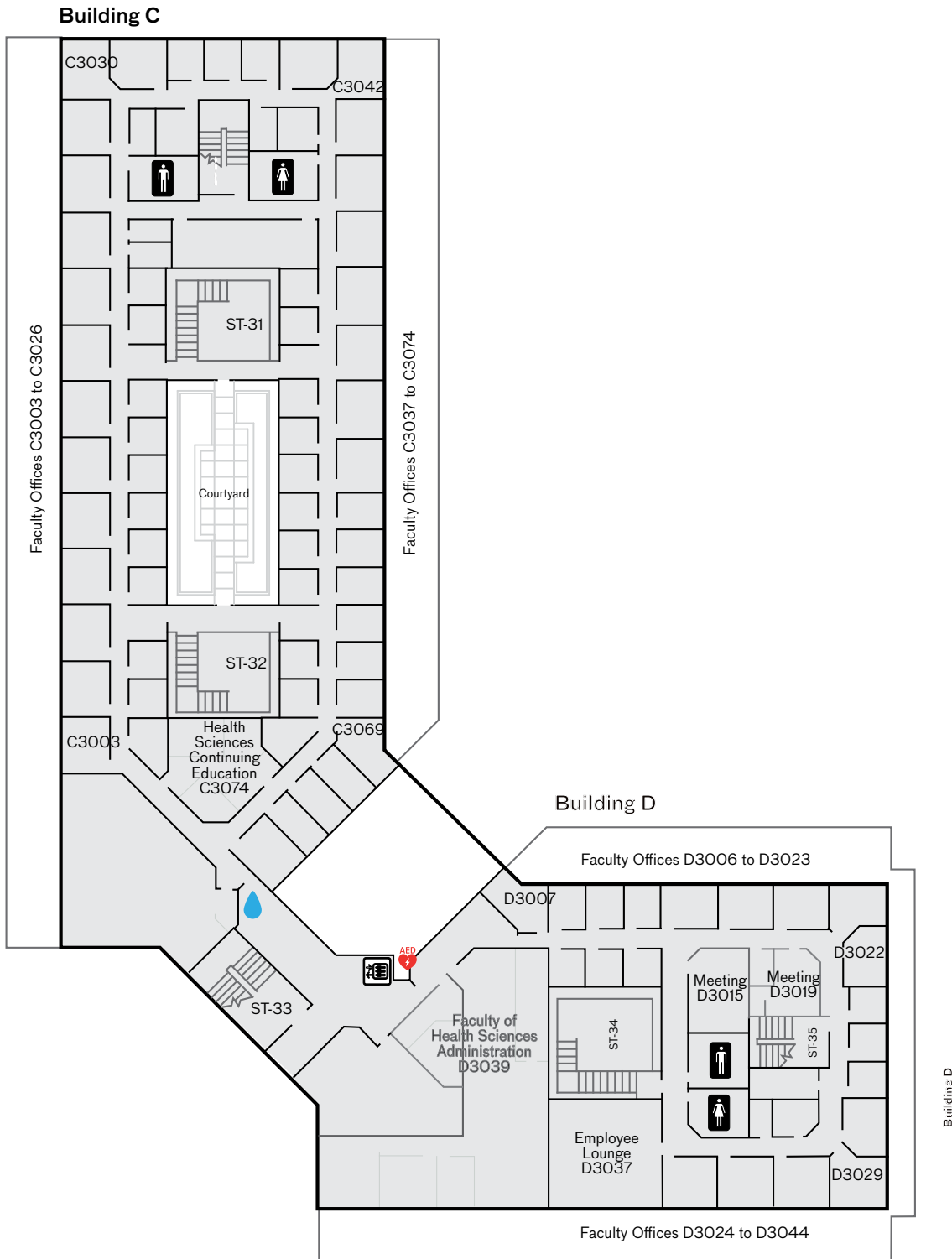
Third Floor - Building C & D Coquitlam Campus



LEVEL 3

- c3074 Faculty of Health Sciences - Continuing Education
- D3039 Faculty of Health Sciences
- c3047 HiPE Research Lab
-  Water Fill Station
-  AED Location

Exterior Building and Parking Map Coquitlam Campus

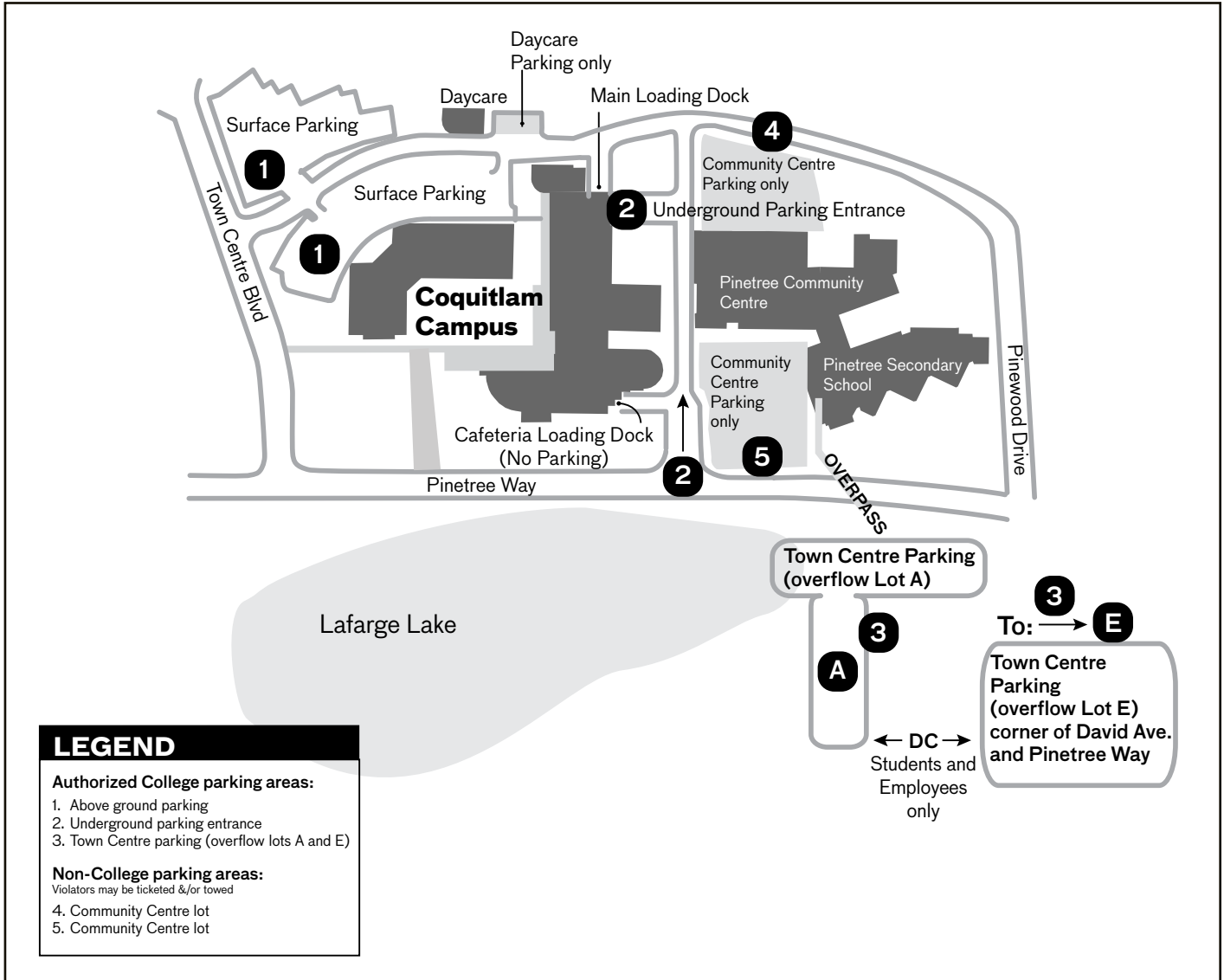

Note: Lots 1 and A and E: Student-pass parking. Lot 2: Employee and hourly parking

CAMPUS STREET ADDRESS

1250 Pinetree Way, Coquitlam, B.C.

MAILING ADDRESS (FOR ALL CAMPUSES)

PO Box 2503, New Westminster, B.C. V3L 5B2

CENTRAL SWITCHBOARD

604 527 5400

CAMPUS HOURS

Monday to Friday 6:30am to 11pm
Saturday 6:30am to 7pm
Sunday & Holidays Closed (limited access*)

* Access at building A/B. Valid and current College ID must be shown to security.

ACCESS FOR VISITORS OR STUDENTS WITH DISABILITIES

Reserved parking for people with disabilities is available in the above ground and underground parking lots.

INFORMATION

Inquiries should be made at Security in the Atrium of Building A/B (main floor).

ROOM NUMBERS

The campus is divided into two buildings: building A/B and building C/D. Room numbers are prefixed by the building letter and floor level. Classrooms are labelled in green on these maps.

FOOD SERVICE

Meals and snacks are available in the cafeteria located on the northeast side of the building A/B Atrium (main floor) and coffee and snacks are available at the kiosk of building C/D (main floor).

SMOKE-FREE CAMPUS

Douglas College is a smoke-free campus. The policy prohibits smoking, vaping and chewing tobacco on all Douglas College Campuses and sites including parkades.

SECURITY

Call 2400 from internal College telephones for all emergencies: fire/police/ambulance/first aid. Security and first aid is located in the Atrium (main floor level) of building A/B.

Security can be contacted at:

Non-emergency: 604 777 6255 or 604 307 4537 (cell).





DOUGLAS COLLEGE